

# HEAVY DUTY TAKE APART HINGE

316 STAINLESS STEEL



Import



Precision  
Cast

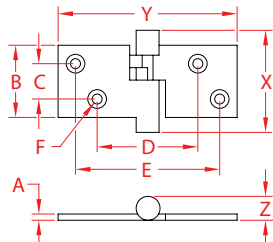
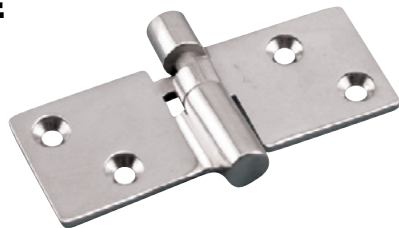

ITEM	A	B	C	D	E	F	X (height)	Y (length)	Z (width)	WT (lb)	PACKAGING TYPE	EACH (qty)	INNER (qty)	CARTON (qty)	UPC
S3824-2000	0.13"	1.45"	0.73"	2.00"	2.90"	0.20"	2.05"	3.54"	0.47"	0.24	POLYBAG	1	1	100	791506058137

**NOTE:**

**USE 4 #10 FASTENERS. HEAVY DUTY HINGE WITH PRECISION CAST COMPONENTS. LOCKING TAB PREVENTS HINGE FROM COMING APART ACCIDENTALLY.**

**REFERENCE "FASTENER MATCHING CHART" FOR COMPATIBLE FASTENERS.**

**ALL DIMENSIONS ARE NOMINAL (+/- 3%) AND ARE SUBJECT TO CHANGE WITHOUT NOTICE.**